



OPERATING MANUAL

MODEL 2570
RAISED BED PLASTIC MULCH LAYER

Table Of Contents

Bed Height.	6
Bed Press.	7
Bed Width	7
Chisel Tooth.	12
Cover Disk	11
Dirt Shield.	11
Drip Irrigation Attachment	15
Drip Tape Down Pipe	15
Getting Started	5
Features	4
Helpful Tips.	30
Options	4
Parts Breakdown, Descriptions	24-28
Parts Breakdown, Exploded Views.	17-23
Plastic Rolls, Installing	8
Plastic Tensioning	8
Plastic Width.	16
Preparation Of Soil	4
Press Wheel	9
Ro-Trak, Maintenance.	14
Ro-Trak, Sensor.	13
Ro-Trak, Trouble Shooting	14
Safety First	3
Trench Opener	10
Trouble Shooting.	31
Warranty	30

!! Safety First !!

- ⚠ No riders beyond the speed of 3 MPH. Operators need to read and understand all the precautions.
- ⚠ Keep people away when lifting and lowering the machine.
- ⚠ Be careful when turning around; machine is 8' long.
- ⚠ Do not crawl under the machine when lifted.
- ⚠ Cover discs are sharp; stay clear.
- ⚠ Do not adjust the machine when it is moving.
- ⚠ Do not stand on machine.
- ⚠ Do not sit on machine except designated seat.
- ⚠ Tractor operator is responsible for extra worker(s) around machine.
- ⚠ Rain-Flo Irrigation is not responsible for accidents if any should occur.

2570 Features

- 70 HP FWD Minimum Tractor Size
- Minimum Row Centers; 50” with 3’ or 60” with 4’ Plastic
- Adjustable Plastic Width from 3’ to 4’
- Adjustable Bed Height from 3” to 7”
- Adjustable Tension Brake on Plastic Roll Carriers
- Adjustable Row Markers
- Operator Seat
- Replaceable, Reversible Plow Share Blades
- UHMW Poly Lined Bed Press
- Bed Press has adjustable side press plates, for More or Less Plastic Coverage
- Quality Powder Coated Paint

Options

- Automatic Self Steering Ro-Trak for Hill Sides
- Single or Double Drip Attachment
- Hydraulic Cover Disk Adjustment
- Crowned Bed Press for Level Fields
- Center Fillers; to Help Fill Center of Bed
- 400 lb. Ground Driven Dry Fertilizer Hopper
- Fumigation Tank Mounts with Gas Knives

Soil Preparation

- * To build a uniform firm bed with no hollow spots, soil has to be prepared properly.
- * All soils are different. Some (moist, sandy) soils make nicer square beds than others. You need to know what soil preparation works best with your soil.
- * Machine performs the best if soil is plowed 6” to 8” deep.
- * Soil should be harrowed or roto-tilled until free of sod lumps.
- * Proper moisture in soil is important to form nice firm beds. For best results, soil should not be powder dry or in muddy condition.

Getting Started

Before laying plastic, you may want to try out the machine by making beds only so you get the feel of the machine.

Adjust 3-point top link on tractor to level the machine.

Let the machine down fully and regulate the amount of soil in front of the machine with the length of the 3-point top link.

It is not necessary to pull more soil than needed to fill the bed. Pulling too much soil may cause tractor slippage, resulting in side drifting.

To get a higher, firmer bed, grower may want to pre-bed (make beds without laying plastic) then come back to lay plastic mulch. This will also help removing shallow spots in the bed. Disk blades can be removed when making beds only.



Bed Height Adjustment

Bed height is adjusted by lifting and lowering the bed press. Use label ruler behind pin indicator (top of pin) located on both sides of the machine to determine bed height(See Below).

To adjust bed height, release the lock handles. Raising the bed is done by two people lifting the deck by hand, or by slowly driving forward with the 3-point hitch in down position. The soil will lift the bed press. To lower the bed, slowly lift 3-point hitch with the tractor to the desired height and lock the handles.

If your bed is not firm and has shallow spots in the center, add weight on the bed press, adjust the top link, and/or install the optional center of bed fillers.

Bed Height Indicator



Lock Handle Adjustment

Important: When bed height is adjusted, bed width (Page 7) and trench openers (Page 10) need to be adjusted accordingly.

3 Ft. Plastic		4 Ft. Plastic	
Bed Height	Bed Width	Bed Height	Bed Width
4"20"	4"30"
6"16"	6"26"
8"12"	8"22"

Bed Width Adjustment

The bed press has adjustable side plates (photo at bottom). These must be adjusted according to bed height by releasing the bolt and sliding the side plates in or out at the slot. ***Make sure bolts are tight to keep them from slipping.*** For setting, follow chart on machine or on Page 6. It is important to maintain enough plastic at the edge for proper coverage.

NOTE; For straight beds, each side must be equally adjusted.



Adjustment Slot
for Side Plates



Adjustable Side Plates

Installing Plastic Rolls

To install plastic rolls, place them on top of rollers (A). Pull end of plastic down in between rollers and underneath bottom roller (B). Secure plastic and drip tape at end of row. Only feed from one roll at a time.

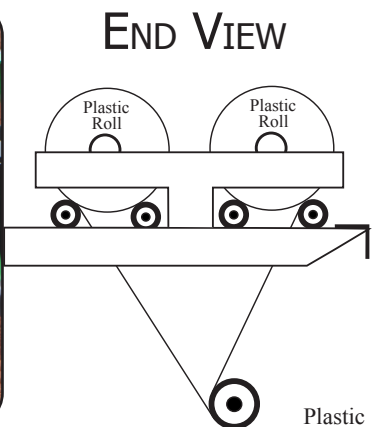
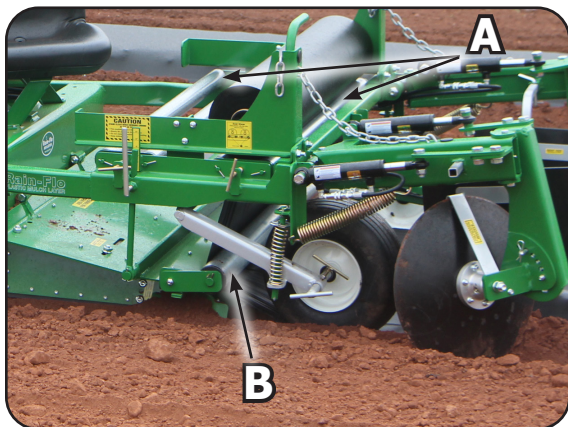

Plastic Tension

Plastic rolls have a tension brake. *Just a slight tension is needed.*

Note; Setting brake tension too tight may affect the performance of the machine and can cause plastic to pull out from under press tires.



Tension
Brake
Adjustment

Press Wheel Adjustment

Press wheels need to run at the bottom of the trench and not on the side to hold the plastic mulch properly. To adjust, loosen T-handle and make left/right changes as needed.

Plastic cross tension is adjusted by the angle of the tire. Rotate the axle to adjust the front of the press wheel on an inward angle to stretch the plastic the preferred amount.

The spring provides down pressure on the press wheel and is important for laying at 2+ mph. Adjust the down pressure by using pin. Avoid excessive spring tension which can cause the plastic to tear. Spring can also be removed if always laying at slow speeds.

*Use less cross tension when laying biodegradable plastic mulch.
Use only high quality plastic to avoid straight line tear.*

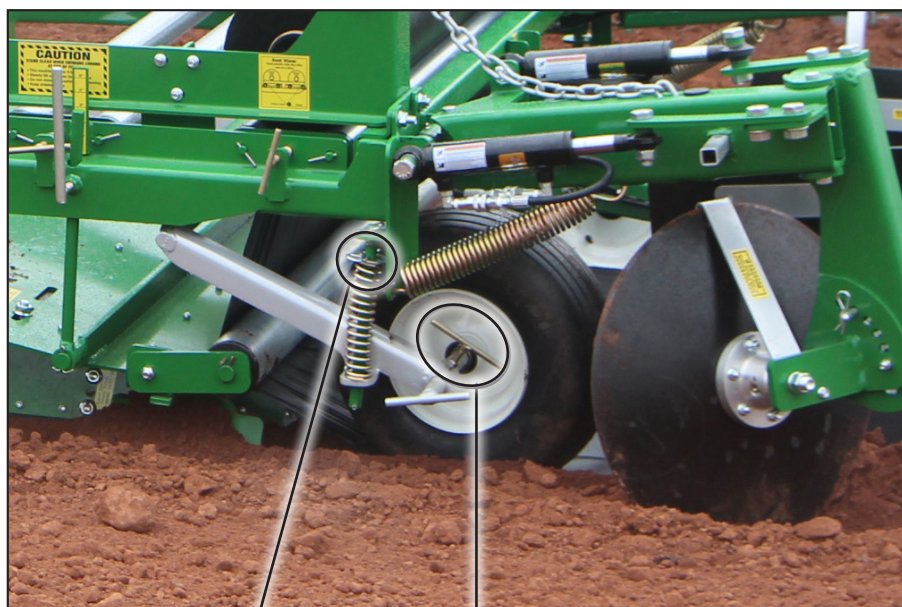

Down pressure
adjustment

Position and
angle adjustment

Trench Opener Adjustment

Trench openers are used to cut a trench along the sides of the bed. This will give a ‘cup’ at the edge of the bed to prevent the plastic from blowing off. If bed height is adjusted, the trench opener has to be adjusted accordingly.

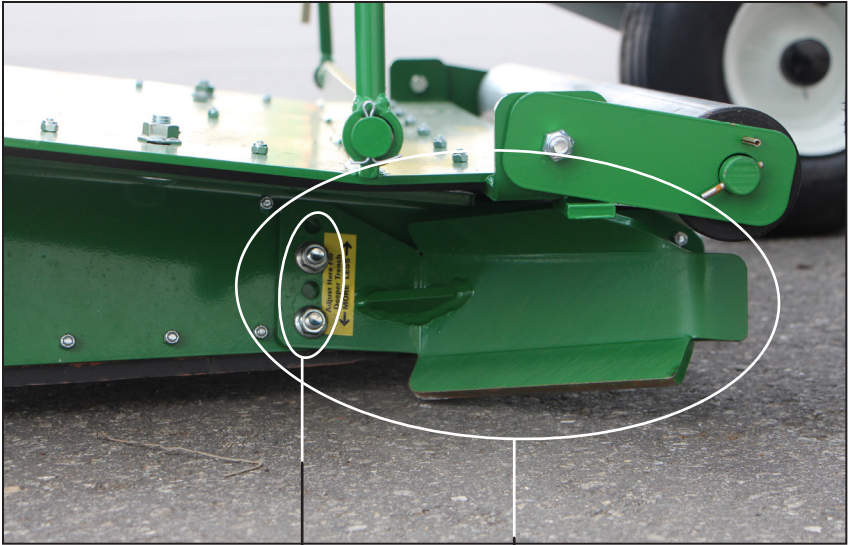

Depth
Setting

Trench
Opener

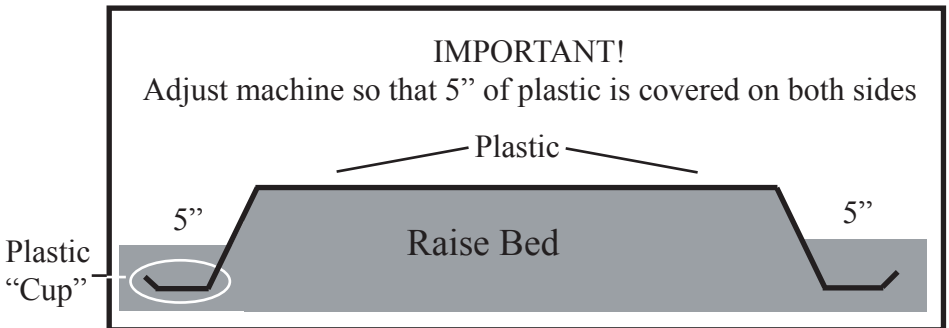

Cover Disk Adjustments

Cover disks and dirt shields need to be adjusted according to soil type and conditions. Use inside turnbuckles to set disks on a 45 degree angle. Make left / right adjustment as needed using the outside turnbuckles. They can be adjusted on-the-go without stopping.

For more or less coverage, tilt disk forward or backward as decal shows (pictured at bottom). Springs can be hooked into different slots to adjust down pressure on the disks.

For heavy clay soil tilt disks upright and use more down pressure.

For sandy loam soil set disks flatter with less down pressure.



Hydraulic cover disks are an option and adjustments can be made from the seat on the machine.

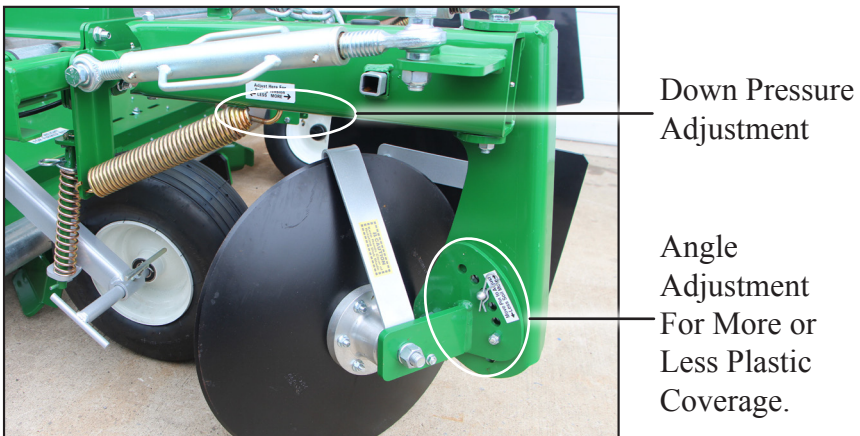

Side Shovel Adjustment

Depth
Adjustment



Side shovels are used to loosen more soil for the cover disks. Adjust according to soil conditions or approximately 1" to 2" below moldboard.

Note; right side shovel is clamped further back on machine when using with optional dry fertilizer attachment.



Notice the amount of soil side shovel is loosening for cover disk.

Auto Ro-Trak

- *Ro-trak has the most benefits on hillsides and contours.
- *Automatically steers to correct machine side drifting.
- *Ro-trak is activated by a sensor at back of machine.
- *Will help prevent the machine from “fish-tailing” on hillsides.

Helpful Tips

- *When installing Hyd pump, lead hoses through 3-point A frame.
- *Inspect and make sensor square to machine.
- *Twelve-volts can be supplied by tractor or a separate battery.
- *Ro-trak requires only low RPM pto speed to function.
- *Hollow bed can effect Ro-trak performance.
- *If machine has been setting for a period of time, it may be necessary to manually move the valve spools to get oil through the system.
- *With PTO pump running, use a Phillips screw driver and push the silver tip of the spool inward approximately 1/4” (Page 14.)
- *Manual Ro-Trak is operated with tractor hyd. and must be steered by tractor operator.

Ro-Trak Sensor

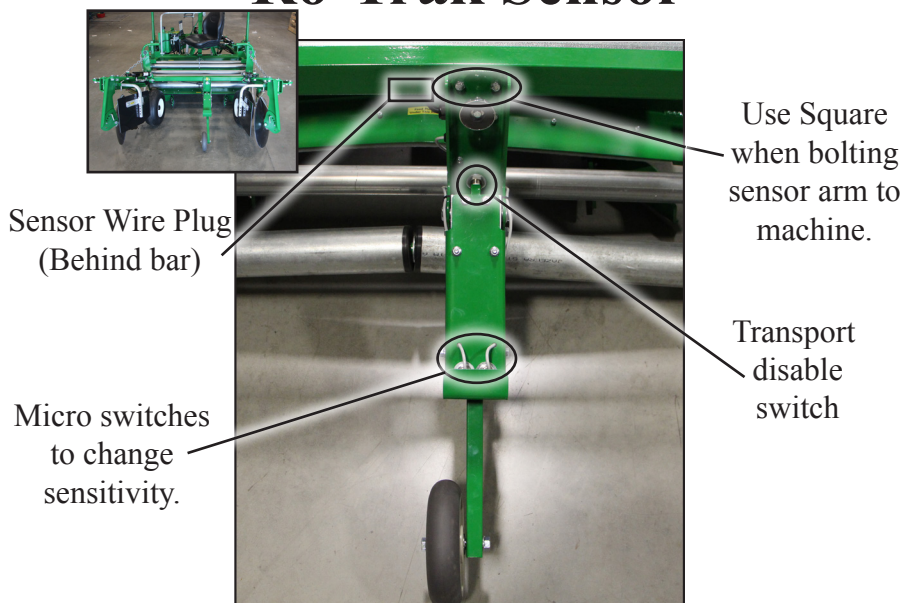

Maintenance

1. Periodically check oil level. Low oil level may cause air to come into the system and effect Ro-Trak performance.
2. Change oil and filter every 200 hours or 3 years (ISO 46 Hyd. Oil).
3. Check for any damaged hoses or electric wires.

Ro-Trak not functioning? Check for these problems.

1. Is the PTO engaged?
2. Is a 12 volt battery properly connected?
3. Is the sensor at rear of machine plugged in?
4. Check oil level.
5. Check for any damaged hoses or wires.
6. Is sensor lifted 3" or more? (Sensor has a transport cut off switch).
7. Do the indicator lights on solenoid light-up?
8. If indicator lights light-up and Ro-trak doesn't function, push in silver pins on solenoid spools (approximately 1/4" on either side).
9. If indicator lights do not light up, undo plate on top of solenoid and check for loose wires.
10. Steers only one way? Change bad steering switch in sensor.
11. Call Rain-Flo at (717) 445-3000.

Auto Ro-Trak



Solenoid Valve

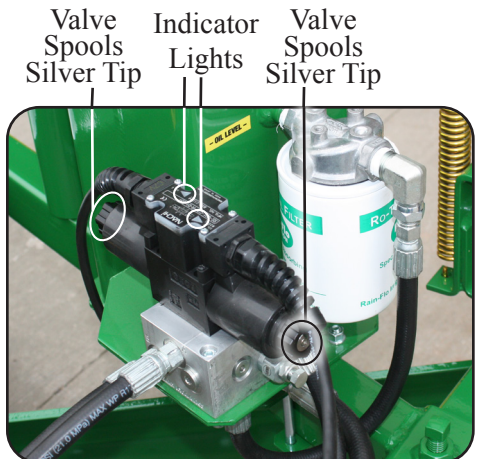

Drip Irrigation Roll Carrier

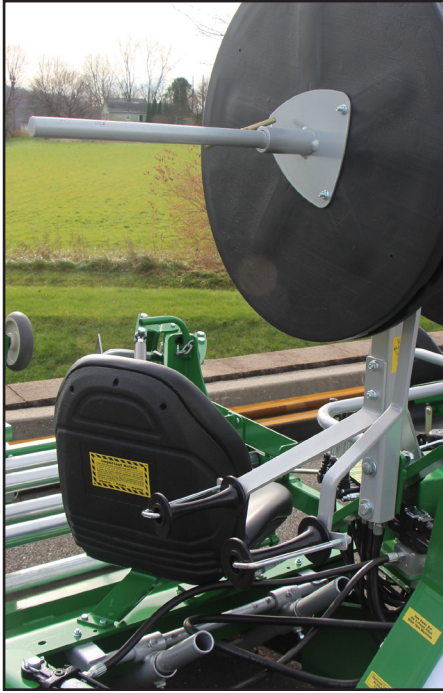

Slide drip roll onto roll carrier rod so that drip emitter will be turned up toward plastic (for less clogging).

Feed drip tape through the guide on the swing arm and through the second guide that's bolted on the drip roll carrier frame. (See sketch below.)

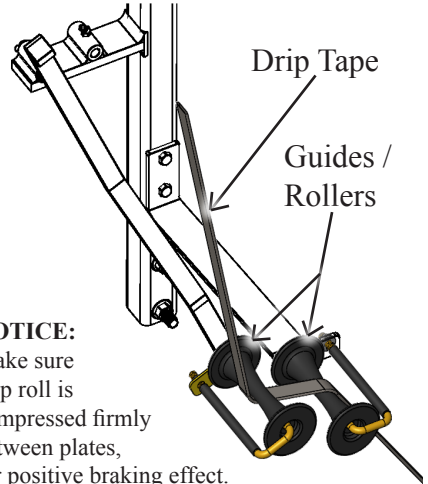

Drip Irr. Tape Placement



Feed drip line through the guides on the spool carrier and into the drip line down pipe.

To avoid damaging drip tape with the press pan, adjust bottom of down pipe about 1" to 2" below the plastic mulch. Turn drip emitters up toward the plastic for less clogging.

Drip Line
Down Pipe

Changing The Plastic Width

The Model 2570 will lay 3' and 4' wide plastic.

- ① To make these adjustments, release the lock bolts at front end of bed shapers (No.1) photo. Remove bolts at back end of bed shaper (No.2) photo and slide to appropriate setting. Make sure bolts are tight.
- ② Adjust bed press side plates; remove bolts from bed press side plates and move to appropriate setting (No. 3) photo.
- ③ Adjust roll holder; loosen bolts and slide bracket so plastic roll fits between bracket (No.4) photo. Adjust approximate 1½" wider than plastic width.

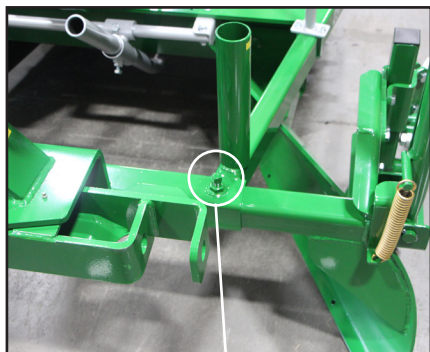

(No.1) Lock Bolt

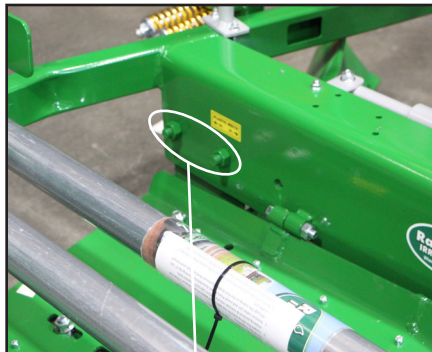

(No.2) Remove bolts on back side of bed shaper



(No.3) Remove bolts from bed press side plates and move to appropriate setting. **NOTE;** For straight beds, each side must be equally adjusted.



(No.4) Roll holder and tire adjustment

Figure 2

2570

18

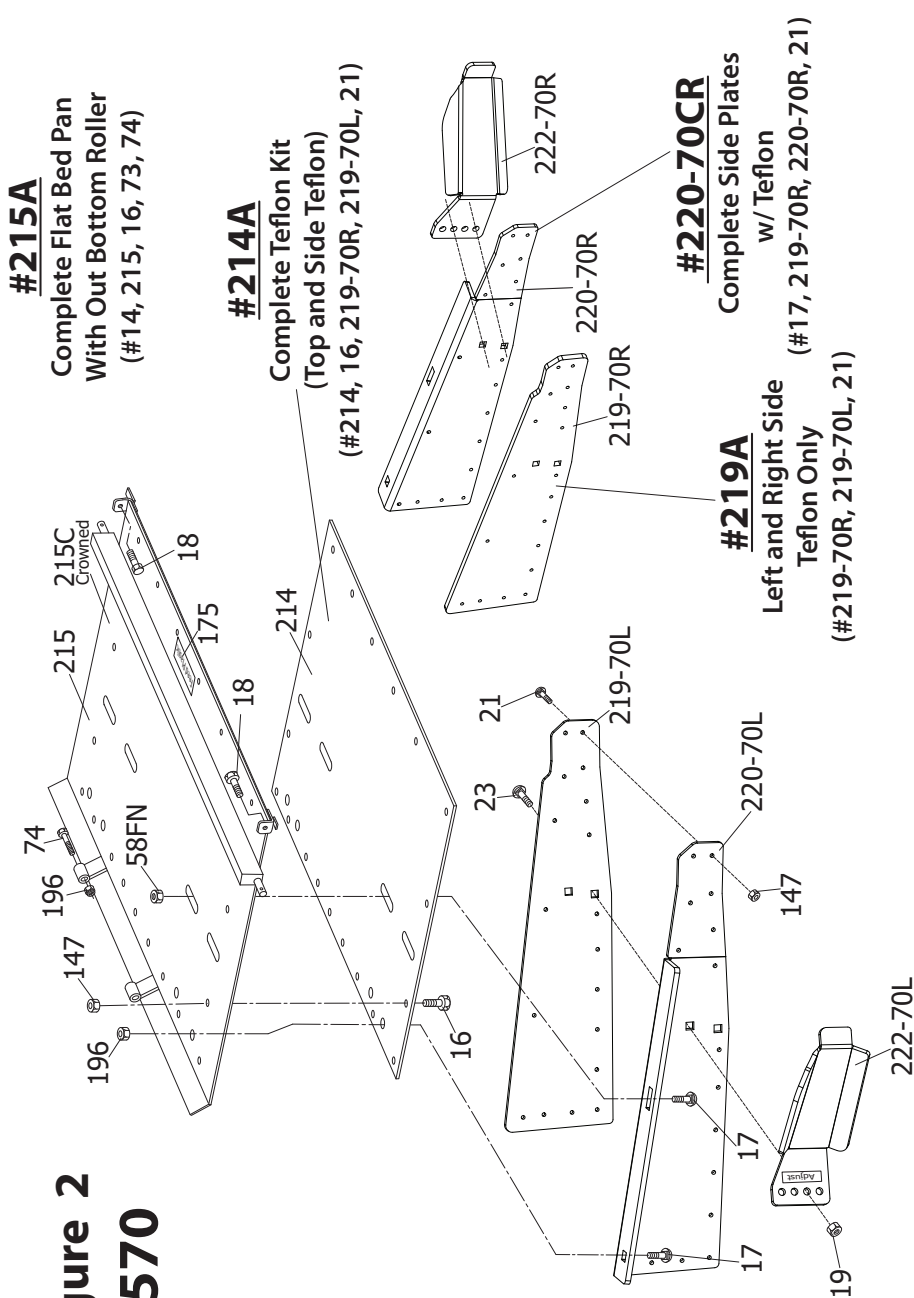

Figure 3

2570

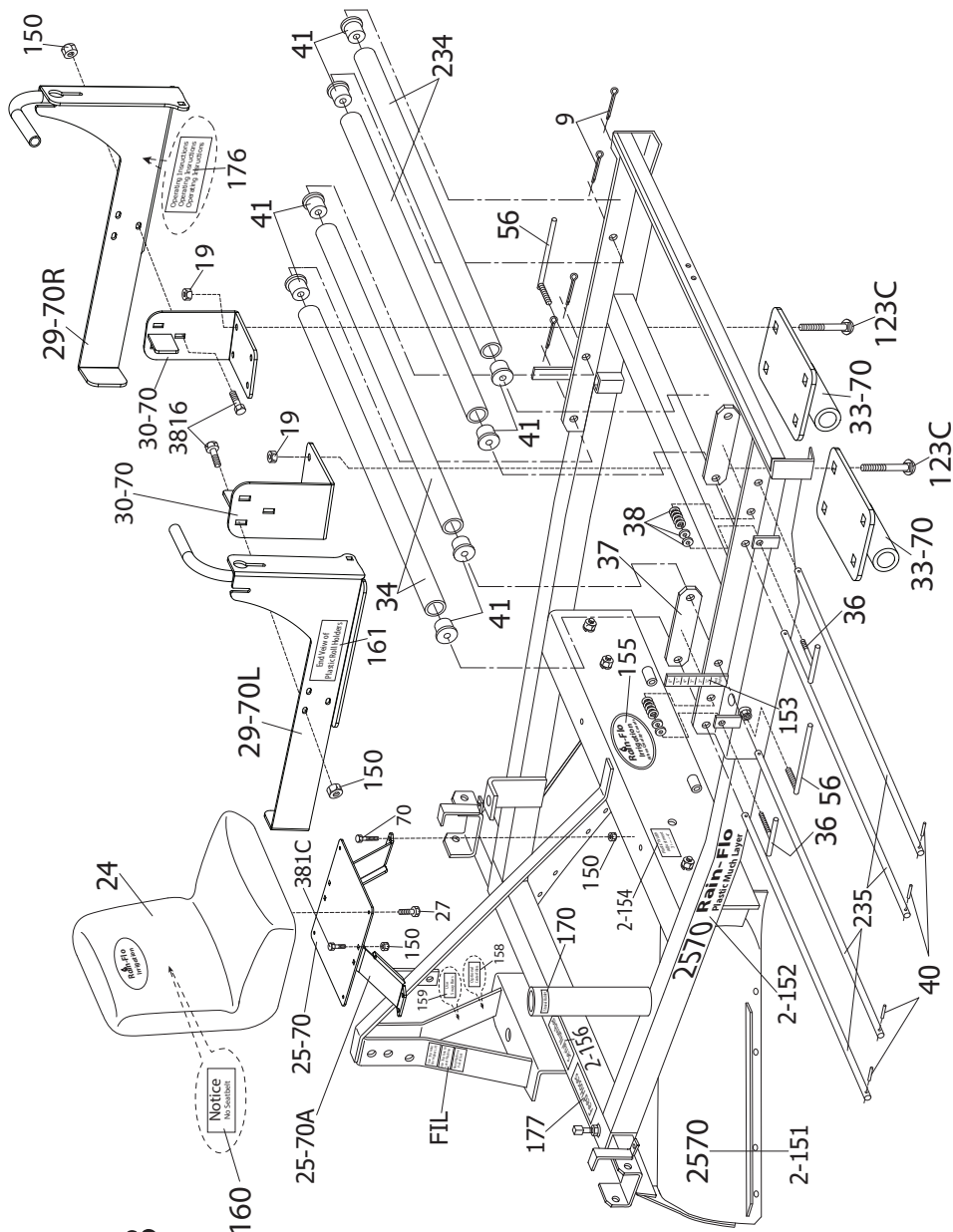
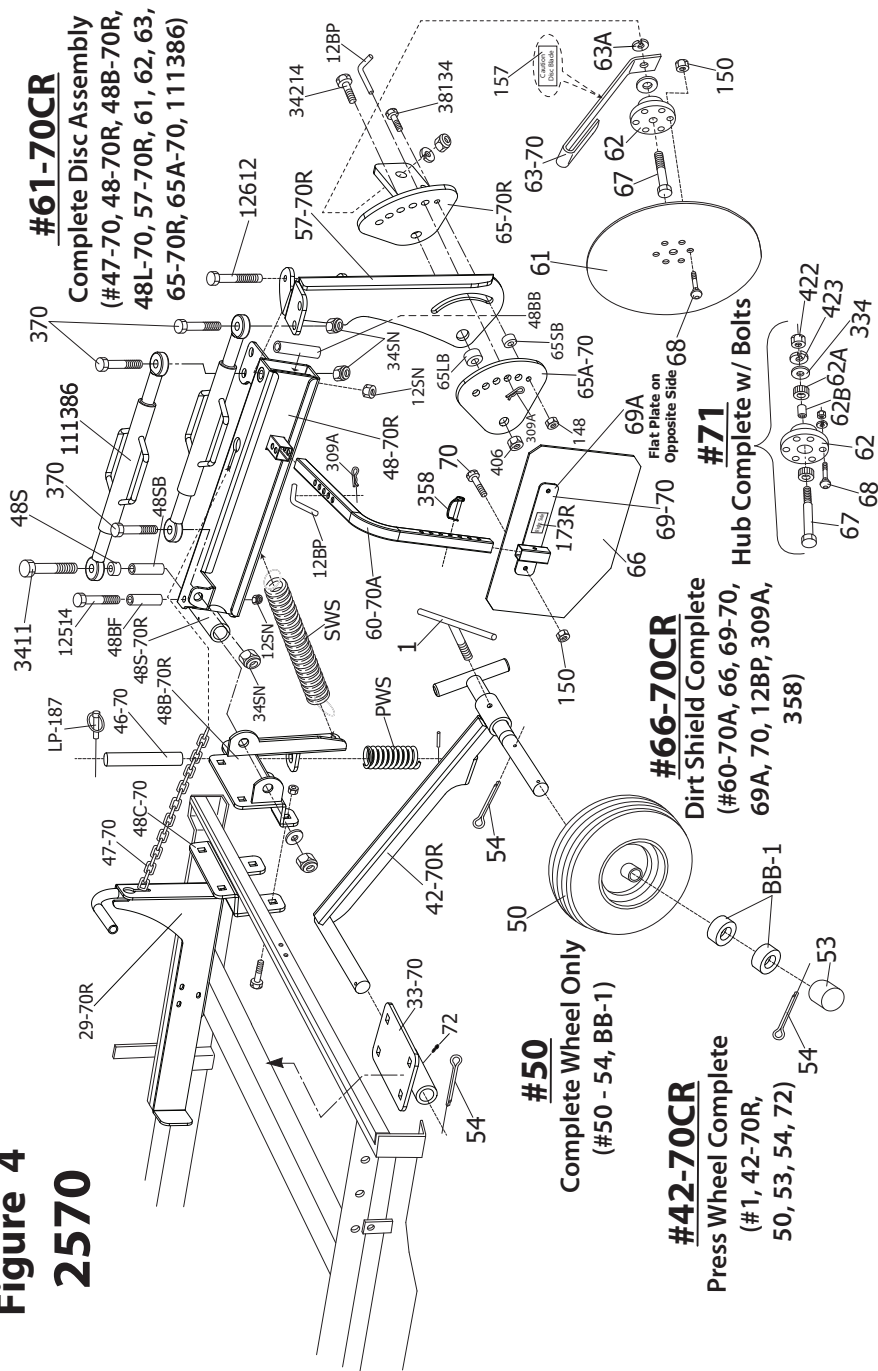

Figure 4

2570



2570

21

2570 Rain-Flo Press Bed Press

2-154 **155** **2-152** **74** **2-153** **215** **18** **75** **273** **54** **278** **76** **277** **175** **174** **196** **73** **54** **149** **40A** **75A** **193** **76** **75** **75A** **18A** **75** **75A**

215A

Complete Flat Bed Press
With Out Bottom Roller
(#214,16,215,74,273,54)

Bottom
(#18A, 75, 75)

#277D

(Also includes 3/8" UHMW teflon bed press)

Bottom Roller Kit

**Complete Flat Bed Press
With Out Bottom Roller
(#214,16,215,74,273,54)**

Crowned Bottom Roller Kit
 (#9, 18A, 234, 235, 40A, 40B,
 40C, 40D, 41, 76, 277C, 278C)

#92CL

2570

(#1, 54, 92L, 93, 94, 95)



**Complete Plow Shear Set with Bolts
(#136F, 136B, 137)**

#98-70CL

Complete Side Shovel Assembly

(#18 - thru - 12114)

Figure 7
2570

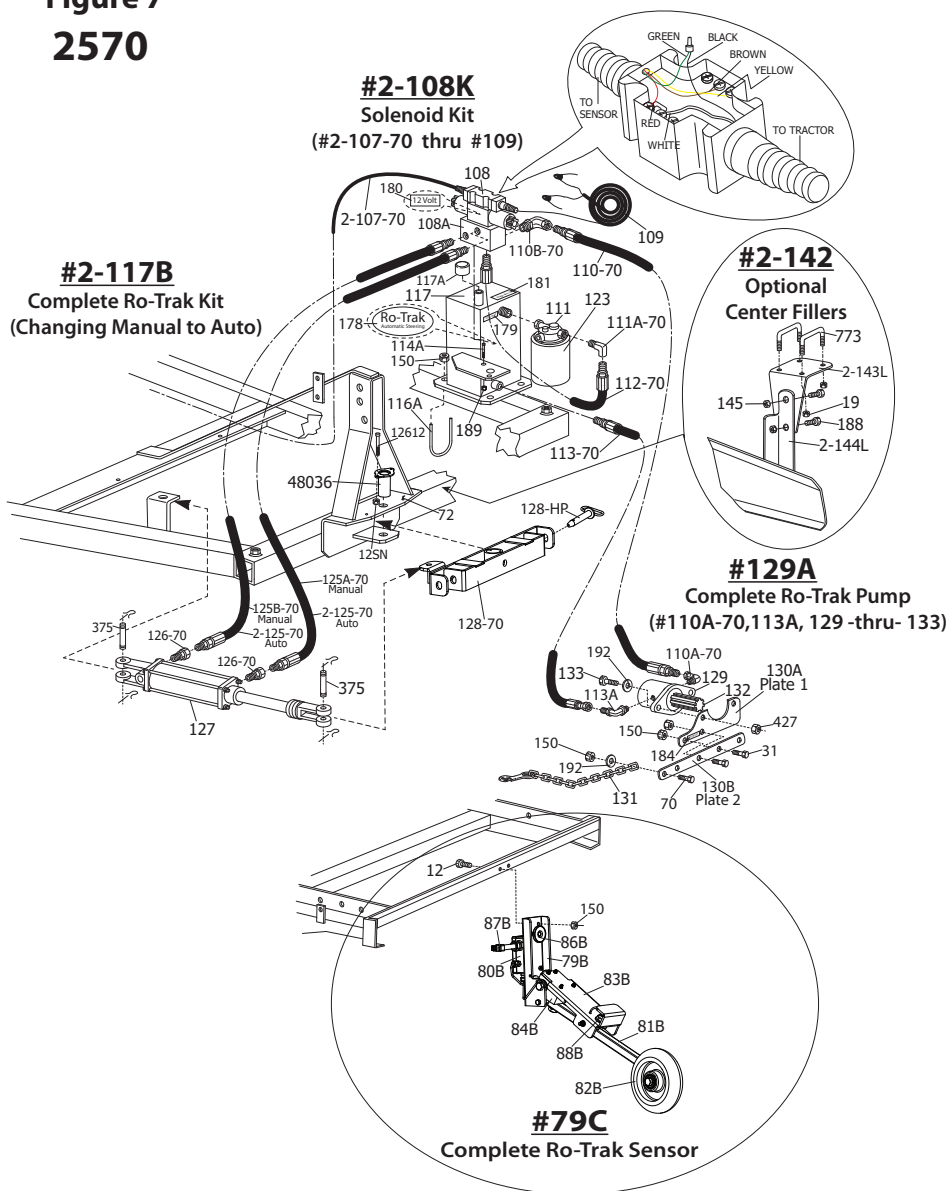

Model 2570 Raised Bed Layer

ITEM #	DESCRIPTION
1..... (3)	Tee Handle
1A.....	Complete Top Drip Roll Carrier
1D.....	Complete Double Top Drip Roll Carrier
2.....	Roll Carrier Clamp
3A.....	Drip Attach Adjustable Brake Tension Plate
3B.....	Drip Attach Brake Plate
3C.....	Drip Attach -- Mounting for Brake Plate
3D.....	Drip Attach Brake Tension Plate Rotation Stop
3E.....	Drip Attach Teflon Brake Washer
3-P..... (2)	Drip Roll Side Plate
5A.....	$\frac{3}{8}$ " x $\frac{1}{2}$ " Set Screw
5..... (2)	$\frac{3}{8}$ " x $\frac{3}{4}$ " Plate Set Screw
6.....	Drip Roll Carrier Frame (Single and Double)
6B.....	Drip Attach Drip Tape Guide Arm
6C.....	Drip Attach Drip Tape Guide Arm (Double Drip)
7.....	1" SAE Washer
8.....	Swing Arm
8B.....	Drip Attach Brake Tension Spring
8C..... (2)	Drip Attach Arm U-Bolt $\frac{3}{8}$ " x 2" x $6\frac{1}{2}$ "
8E..... (2)	Drip Attach Arm Plastic Roller
8F.....	Drip Attach Arm U-bolt Plate Only
9..... (7)	Cotter Pin[$\frac{1}{8}$ "]
10.....	Drip Roll Shaft
11..... (3)	Rubber Brake Assembly
12BP..... (4)	$\frac{1}{2}$ " x $1\frac{1}{2}$ " Pin
12SN..... (6)	$\frac{1}{2}$ " Zinc Stover Nut
13.....	Straight Grease Fitting
16.....	$\frac{1}{4}$ " x $\frac{7}{8}$ " Machine Screw
17..... (12)	$\frac{5}{8}$ " x 2" Carriage Bolt
18..... (2)	$\frac{1}{2}$ " x $1\frac{3}{4}$ " Bolt
19..... (10)	$\frac{1}{2}$ " Flange Nut
20..... (3)	$\frac{5}{16}$ " x $\frac{3}{4}$ " Carriage Bolt
21..... (4)	$\frac{1}{4}$ " x 1" Machine Screw
22..... (3)	$\frac{5}{16}$ " x 1" Thumb Screw
23..... (4)	$\frac{1}{2}$ " x $1\frac{1}{2}$ " Carriage Head Bolt
24.....	Cushion Seat
25-70.....	Seat Mounting
26..... (3)	$\frac{3}{8}$ " x $3\frac{3}{4}$ " Bolt
27..... (4)	$\frac{5}{16}$ " x $\frac{1}{2}$ " Bolt
28.....	Frame
29-70L.....	Roll Support Plate (Left Side)
29-70R.....	Roll Support Plate (Right Side)
30-70..... (2)	Roll Width Adjustment Plate
31..... (6)	$\frac{3}{8}$ " x 1" Bolt
32..... (8)	$\frac{1}{2}$ " x 4" Carriage Bolt
33-70..... (2)	Bottom Plate Roll Width Adjustment
34SN..... (6)	$\frac{3}{4}$ " Zinc Stover Nut
36..... (2)	Tension Tee Handle

Model 2570 Raised Bed Layer

ITEM #	DESCRIPTION
37..... (2)	Tension Plate
38..... (2)	Tension Spring Washers
40..... (9)	3/16" x 2" Roll Pin
40A..... (2)	3/16" x 1" Roll Pin
40B..... (2)	3/16" x 1½" Roll Pin
40C..... (2)	¼" x 1" Roll Pin
40D..... (2)	¼" x 2" Roll Pin
41..... (8)	UHMW Bushing
42-70CL..... (2)	Left Side Press Wheel Arm Complete
42-70CR..... (2)	Right Side Press Wheel Arm Complete
42-70L..... (2)	Left Side Press Wheel Arm
42-70R..... (2)	Right Side Press Wheel Arm
46-70..... (2)	Press Wheel Tension Spring Rod
47-70..... (2)	Cover Arm Chain
48C-70..... (2)	Disk Arm Swivel Bracket Clamp
48S..... (2)	¾" x 1¾" Disk Arm Bolt Spacer
48-70L..... (2)	Left Side Cover Disk Support Arm
48-70R..... (2)	Right Side Cover Disk Support Arm
48BB..... (2)	Back Disk Arm Bushing; ¾" OD x ½" ID x 4⅛"
48BF..... (2)	Front Disk Arm Bushing; ¾" OD x ½" ID x 4¼"
48B-70L..... (2)	Left Side Disk Arm Swivel Bracket
48B-70R..... (2)	Right Side Disk Arm Swivel Bracket
48SB..... (2)	Bushing For Swivel Bracket; 1¼" OD x ¾" ID x 5.97"
48S-70L..... (2)	Left Side Disk Arm Swivel Knuckle
48S-70R..... (2)	Right Side Disk Arm Swivel Knuckle
49..... (4)	¾" x 3" Zinc Grade 5 Hex Bolt
50..... (2)	Press Wheel Tire (#50 -thru- #54; BB-1)
53..... (2)	Hub Cap
54..... (10)	Cotter Pin
57-70L..... (2)	Left Side Vertical Hub Mounting Bracket
57-70R..... (2)	Right Side Vertical Hub Mounting Bracket
58..... (2)	Cotter Pin
58FN..... (2)	⅝" Flange Nut
58SN..... (2)	⅝" Zinc Stover Lock Nut
60-70A..... (2)	Dirt Shield Support Arm
61..... (2)	20" Disk Blade
61-70CL..... (2)	Left Side Complete Disk Assembly
61-70CR..... (2)	Right Side Complete Disk Assembly
62A..... (4)	205KR3 Bearing
62B..... (2)	Spacer
63-70..... (2)	Disk Dirt Scraper
63A..... (2)	¾" Extension Tooth Lock Washer
65-70L..... (2)	Left Side Bracket For Disk Hub Mounting
65-70R..... (2)	Right Side Bracket For Disk Hub Mounting
65A-70..... (2)	Mounting Plate For Tee Bracket
65LB..... (2)	Large Disk Bracket Bushing; 1⅞" OD x ¾" ID x 7/16"
65SB..... (2)	Small Disk Bracket Bushing; ⅝" OD x ¾" ID x 7/16"
66..... (2)	Dirt Shield

Model 2570 Raised Bed Layer

ITEM

DESCRIPTION

66-70CL.....	Left Side Dirt Shield Complete
66-70CR.....	Right Side Dirt Shield Complete
67..... (2)	$\frac{3}{4}$ " x $4\frac{1}{2}$ " Hub Center Bolt
68..... (12)	$\frac{3}{8}$ " x $1\frac{1}{2}$ " Button Socket Cap Bolt
69-70..... (2)	Dirt Shield Bracket w/ Square Tubing
69A..... (2)	Dirt Shield Flat Plate Bracket
70..... (6)	$\frac{3}{8}$ " x $1\frac{1}{4}$ " Bolt
71..... (2)	6-Bolt Hub Complete
72..... (3)	$\frac{1}{4}$ " x 90° Grease Zerk
72A..... (4)	$\frac{1}{4}$ " NPT 45° Grease Zerk
74..... (2)	$\frac{5}{8}$ " x $3\frac{1}{2}$ " Bolt
75.....	Right Side Bottom Roller Flex Plate [Flat Bed]
75A.....	Left Side Bottom Roller Flex Plate [Flat Bed]
75C..... (2)	Bottom Roller Flex Plate [Crowned Bed]
76..... (2)	UHMW Bushing; Bottom Roller
79B.....	Sensor Vertical Mounting Bracket
79C.....	Complete Ro-Trak Sensor Assembly #79B - 88B
80B.....	Box Enclosure
81B.....	Ro-Trak Sensor Arm
82B.....	Sensor Tracking Wheel
83.....	$\frac{1}{2}$ " x $4\frac{1}{4}$ " Bolt
83B.....	Sensor Body Frame
84B.....	Ro-Trak Sensor Aluminum Block Bearing
85B.....	Ro-Trak Sensor Aluminum Block
86B.....	Ro-Trak Sensor Magnet
87A.....	Sensor Electric Plug Shroud / 4 -Square
87B.....	Sensor Electric Plug-In / 4 -Square
88B.....	Ro-Trak Sensor Proximity Sensor Switch
89..... (5)	$\frac{1}{4}$ " x $\frac{3}{4}$ " Carriage Head Bolt
90.....	$\frac{5}{16}$ " x $\frac{3}{4}$ " Bolt
92L.....	Left Side Row Marker
92R.....	Right Side Row Marker
92CL.....	Left Side Complete Row Marker
92CR.....	Right Side Complete Row Marker
93..... (2)	Row Marker Extension
94..... (2)	Row Marker Spring
95..... (2)	Row Marker Hinge Pin
97-70..... (2)	Side Shovel Mounting Bracket
97A..... (2)	Side Shovel Mounting Clamp
98-70CL.....	Left Side Complete Side Shovel Assembly
98-70CR.....	Right Side Complete Side Shovel Assembly
99-70L.....	Side Shovel Stem; Left Side
99-70R.....	Side Shovel Stem; Right Side
100-70L.....	Side Shovel Shank; Left Side
100-70R.....	Side Shovel Shank; Right Side
105..... (4)	$\frac{3}{4}$ " x 2" Carriage Bolt
108.....	Solenoid Valve
108A.....	Aluminum Manifold
109.....	Solenoid Power Cord w/ Battery Clips
110-70.....	Hose, Pump Pressure Side
110A-70..... (2)	Hyd. Pump Elbow; $\frac{1}{2}$ " MJ x $\frac{5}{8}$ " MB
110B-70.....	Hydraulic Block Elbow
111.....	Filter Head

Model 2570 Raised Bed Layer

ITEM

DESCRIPTION

111A-70	Hyd. Filter Head Elbow Fitting
112-70	Hydraulic Hose; Filter to Solenoid Manifold
113-70	Hydraulic Hose; Pump Intake Side
113A..... (2)	Hyd. Pump Elbow; ½" MJ x ¾" MB
114A.....	5/16" x 2½" Socket Head Cap Bolt
115..... (2)	Hydraulic Tank Mounting Plate
116..... (4)	¾" x 4" Bolt
116A..... (4)	¾" x 2" U-Bolt For Oil Reservoir
117	Oil Reservoir
117A.....	Fill Cap
118.....	Bottom Drip Attach Cross Bar
118A.....	Complete Single Bottom Drip Attach
118D	Complete Double Bottom Drip Attach
120..... (2)	½" x 1½" Hex Bolt
121.....	Drip Line Down Pipe
123.....	Oil Filter
125A-70	Hyd. Cylinder Hose[Manual RoTrak], Front Hose
125B-70	Hyd. Cylinder Hose[Manual RoTrak], Back Hose
126-70 (2)	Hyd. Adapter w/ Flow Orifice; ¾" MJ x ¾" MB
127.....	Hydraulic Cylinder
128-70	Steering Bar
128-HP	Steering Bar Hitch Pin
129.....	Hydraulic Pump
129A.....	Ro-Trak Pump Complete
130A.....	Pump Support (Plate #1)
130B.....	Pump Support (Plate #2)
131.....	Chain w/ Snap
132.....	PTO Coupling
133..... (3)	¾" x 1½" Bolt
134.....	Bottom Drip Attach Bolted Angle Iron
135.....	Drip Pipe Holder Bracket
136..... (4)	Plow Shear Set Complete
136B..... (2)	Back Plow Shears
136F..... (2)	Front Plow Shears
137..... (9)	¾" x 1¼" Plow Bolt
145..... (2)	7/16" Hex Nut
146..... (16)	½" Hex Nut
147..... (10)	¼" Nylon Lock Nut
148..... (3)	¾" Nylon Lock Nut
149..... (2)	½" Nylon Lock Nut
150..... (16)	¾" Flange Nut
154..... (2)	Caution Label [For Roll Holder]
155..... (2)	Rain-Flo Oval Logo Label
157..... (2)	Disc Scraper Caution Label
158.....	Center Bed Fillers Label ["A" Frame]
159.....	Sway Bar Label ["A" Frame]
160.....	Important Notice Label [Seat]
161..... (2)	End View Label [Roll Holder]
162..... (4)	More Coverage Label
167..... (2)	Deeper Trench Label
168.....	Notice Label on Drip Attach
168A.....	"Turn Drillers Up For Less Clogging" Label

Model 2570 Raised Bed Layer

ITEM #	DESCRIPTION
169.....	Direction Arrow for Drip Attach
169A.....	Drip Attach Brake Adjustment Plate Label
170.....	Shovel Holder Label
172L.....	Left Side Standing in Back Label For Disk
172R.....	Right Side Standing in Back Label For Disk
173L.....	Left Side Standing in Back Label For Dirt Shield
173R.....	Right Side Standing in Back Label For Dirt Shield
174..... (2)	Bed Width Label
175..... (2)	Feed Plastic Under Roller Label
177..... (2)	Feed Hoses through "A" Frame Label
178.....	Oval Ro-Trak Label
179.....	Oil Level Label
180.....	12 Volt System Label
181.....	Hydraulic Oil Label
183.....	Make Sensor Square Label
184.....	Ro-Trak Chain Caution Label
185..... (2)	This Side Up Label
189.....	5/16" Nylon Lock Nut
192..... (6)	3/8" Flat Washer
193..... (6)	1/2" Flat Washer
194..... (6)	5/8" Flat Washer
195..... (3)	5/16" Flange Nut
196..... (6)	5/8" Nylon Lock Nut
197..... (2)	7/16" Flat Washer
198..... (2)	7/16" Locking Washer
199.....	1 1/4" Nylon Lock Nut
201..... (2)	1/2" x 3 1/4" Bolt
214.....	3/8" UHMW Plastic (Machine Serial # Needed)
214A.....	Complete Plastic Kit (Top & Side Plastic)
215.....	Bed Press Plate [Flat]
215AC.....	Bed Press Complete W/O Bottom Roller
215C.....	Bed Press Plate [Crowned]
219A.....	Complete Set 1/2" UHMW Plastic Side Plate
219-70L.....	Left Side 1/2" UHMW Plastic Side Plate
219-70R.....	Right Side 1/2" UHMW Plastic Side Plate
220-70CL.....	Left Side Complete Side Plate with Plastic
220-70CR.....	Right Side Complete Side Plate with Plastic
220-70L.....	Bed Press Side Plate (Machine Serial # Needed)
220-70R.....	Bed Press Side Plate (Machine Serial # Needed)
222-70L.....	Left Side Trench Opener
222-70R.....	Right Side Trench Opener
234..... (4)	Plastic Mulch Support Roll
235..... (4)	Roll Holder Rod
273..... (2)	Bed Height Adjustable Rod [Flat Bed]
273C..... (2)	Bed Height Adjustable Rod [Crowned Bed]
277.....	3" Galvanized Bottom Roller [Flat Bed]
277A.....	Complete Flat Bed Bottom Roller Kit
277B.....	Complete Crowned Bed Bottom Roller Kit
277C.....	3" Galvanized Bottom Roller [Crowned Bed]
277D.....	Crowned Press Pan Conversion Kit
278.....	Bottom Roller Mounting Rod [Flat Bed]
278C.....	Bottom Roller Mounting Rod [Crowned Bed]

Model 2570 Raised Bed Layer

ITEM

DESCRIPTION

279.....	Sensor Mounting Support
279A.....	Complete Ro-Trak Sensor Assembly
287.....	Sensor Electric Plug-In
2-104.....	Scraper Mold Board
2-107-70.....	Rear Sensor Wire Assembly
2-108K.....	Solenoid Kit (Includes Wiring Harness)
2-117B.....	Complete Ro-Trak Kit (Manual to Auto)
2-125-70 (2).....	Hydraulic Cylinder Hose (Auto Ro-Trak)
2-142.....	Center Filler Set Complete
2-143L.....	Left Side Top Center Filler Bracket
2-143R.....	Right Side Top Center Filler Bracket
2-144L.....	Left Side Center Filler Plow Bracket
2-144R.....	Right Side Center Filler Plow Bracket
2-151..... (2).....	Mold Board Label
2-152..... (2).....	Side Label
2-153..... (2).....	Bed Height Label
2-154.....	Caution Label for Roll Holder
2-155..... (2).....	Rain-Flo Oval Logo Label
2-156.....	Plastic Width Label
309A..... (4).....	Safety Pin
334.....	$\frac{3}{4}$ " SAE Flat Washer
358..... (2).....	$\frac{3}{8}$ " x $1\frac{3}{4}$ " Snap Pin
370..... (6).....	$\frac{3}{4}$ " x 3" Gr. 5 Zinc Hex Bolt
375..... (2).....	Cylinder Pin
401..... (4).....	Eye Bolt For Side Shovel
404..... (4).....	Pressed Washer
405..... (4).....	Spring For Side Shovel
406..... (2).....	$\frac{3}{4}$ " Nylon Lock Nut
418..... (2).....	$\frac{9}{8}$ " x $1\frac{1}{2}$ " Sq. Head Set Screw
422..... (6).....	$\frac{3}{4}$ " Hex Nut
423..... (2).....	$\frac{3}{4}$ " Locking Washer
427..... (19).....	$\frac{3}{8}$ " Hex Nut
433..... (6).....	$\frac{5}{8}$ " Hex Nut
592.....	$\frac{1}{2}$ " x 2" Hex Bolt
773.....	$\frac{1}{2}$ " x 4" x $3\frac{1}{16}$ " Center Filler "U" Bolt
3411..... (2).....	$\frac{3}{4}$ " x 11" Gr. 5 Zinc Hex Bolt
12114..... (8).....	$\frac{1}{2}$ " x $1\frac{1}{4}$ " Gr. 5 Zinc Hex Bolt
12514..... (2).....	$\frac{1}{2}$ " x $5\frac{1}{4}$ " Gr. 5 Zinc Hex Bolt
12612..... (4).....	$\frac{1}{2}$ " x $6\frac{1}{2}$ " Gr. 5 Zinc Hex Bolt
34214..... (2).....	$\frac{3}{4}$ " x $2\frac{1}{4}$ " Gr. 5 Zinc Hex Bolt
38134..... (2).....	$\frac{9}{8}$ " x $1\frac{3}{4}$ " Gr. 5 Zinc Hex Bolt
48036.....	Steering Bar Pin
111386..... (4).....	Disk Arm Turnbuckle (13", $1\frac{1}{8}$ " ACME)
FIL.....	Front Instruction Label
LP-187..... (2).....	$\frac{3}{16}$ " x 1" Lynch Pin
PWS..... (2).....	Press Wheel Compression Spring
SWS..... (2).....	Disk Arm Spring

Helpful Tips

- *Adjust 3-point top link on tractor to level machine.
- *Periodically check for shallow spots in bed; hollow bed will effect planting and hinder plant growth.
- *We recommend two or more people when laying plastic mulch to maintain proper machine adjustment.
- *A sizable tractor is needed for stability and lifting power. Minimum tractor size for Model 2570 is 60 HP.
- *This machine can also be used for a bedder only, (without laying plastic). The rear cover disks and tires can be removed for this application.
- *Avoid over steering; rear cover disk will move to far and cut into plastic. Careful steering will also provide more uniform coverage.
- *Stretching plastic in length and side to side will help plastic from blowing off.
- *Check drip tape down pipe for wearing to avoid damaging drip tape from sharp edges.

Warranty

All Rain-Flo mulch layers have a two year warranty against defects in material and workmanship.

If any part is found defective, return the defective part with serial No. of the machine. If Rain-Flo finds it defective, it will be replaced or repaired at no charge.

Call Customer Service at (717) 445-3000

TROUBLESHOOTING

- 1. PROBLEM:** Machine tends to drift sideways causing press wheels to come off the plastic.

SOLUTION:

- *Pull less soil by lengthening 3-point top link.
Pull just enough to fill the bed firm.
- *Ensure the tractor's sway bars are locked.
- *Tractor may be too small.
- *On Auto Ro-Trak machines, make sure Ro-Trak is functioning properly.

- 2. PROBLEM:** Cover disk not getting enough soil to cover plastic

SOLUTION:

- *Tilt disks back to dig in more (Page 11).
- *Set side shovels deeper (Page 12).
- *Increase down pressure on disks (Page 11).
- *Bed press side plates not set correctly for bed height (Page 6 & 7).

- 3. PROBLEM:** Plastic not staying under press wheel.

SOLUTION:

- *Tension is too tight on plastic roll carrier.
- *Bed press side plates not set correctly for bed height (Page 6 & 7).

- 4. PROBLEM:** Ro-Trak not functioning.

SOLUTION: *Follow Ro-Trak information; Page 13 and 14.

- 5. PROBLEM:** Beds aren't firm and shallow spots in center.

SOLUTION:

- *Adjust top link.
- *Soil not tilled deep enough.
- *Add weight on bed press.
- *Tractor's 3-point not lowered completely or draft control lifting up.
- *Install optional center fillers on mulch layer.

~2021 Edition~

Rain-Flo Irrigation
(717) 445-3000